

GREAT SEQUOIA CORP.

3F, NO. 57, FU-HSING NORTH ROAD, TAIPEI, TAIWAN

TEL: 886-2--2771-0164

FAX: 886-2--2773-3342

Website: www.sequoia.com.tw

E-MAIL: sequoia@ms10.hinet.net

G3LL

- THREE PIECE BODY
- FULL PORT
- NPT THREADS TO ANSI B1.20.1
- BLOWOUT PROOF STEM
- LIVE-LOADED PACKING
- LOCKING LEVER HANDLE
- READILY ADAPTS TO AUTOMATION
- FLOATING BALL
- 2000 P.S.I W.O.G. 1/4"-1"
- 1500 P.S.I. W.O.G. 1-1/4"-3"

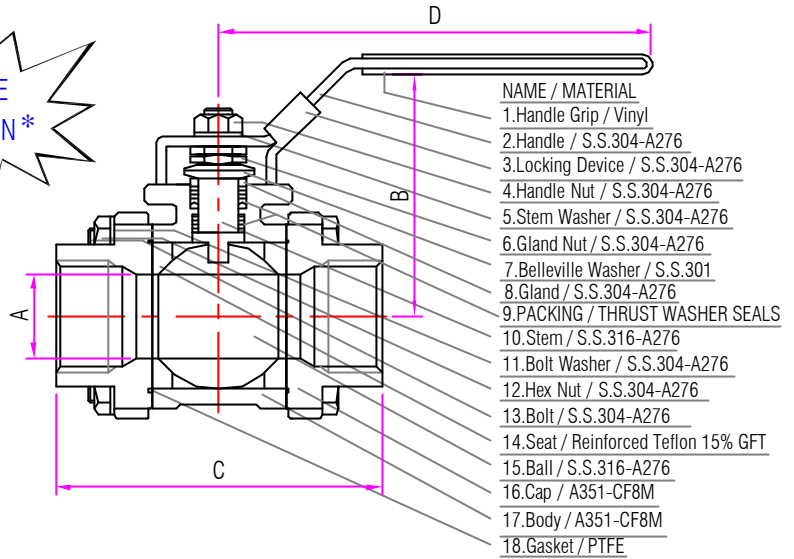
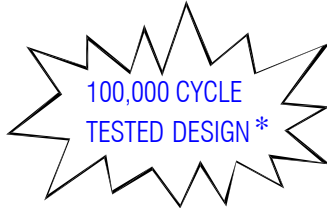

PACKING / THRUST WASHER SEALS

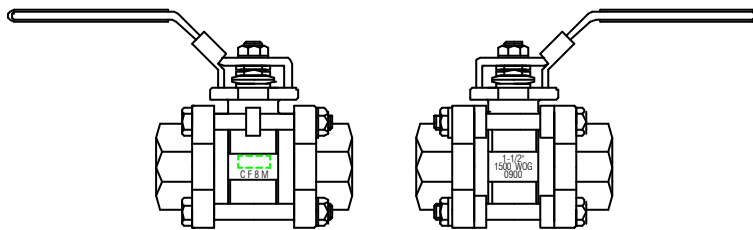
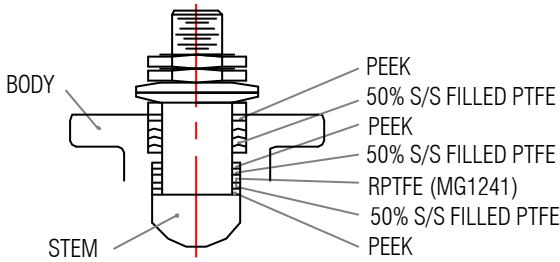

BODY STYLE 1/4" TO 1-1/4"

BODY STYLE 1-1/2" TO 3"

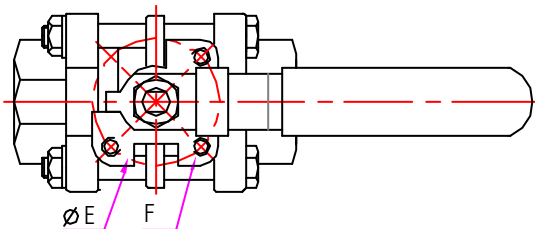

NOTE :1) *ON APPROVED SERVICES

2) THE PACKING SET CANNOT BE INSTALLED TO STANDARD G3 MODELS

DIMENSIONS

SIZE	DIMENSIONS						CV FACTOR	WEIGHTS KGS/LBS
	(mm/in) A	(mm/in) B	(mm/in) C	(mm/in) D	(mm/in) E	(mm/in) F		
8 1/4"	9.5	71.5	60	120	36	M6	10	0.434
	0.374	2.815	2.362	4.724	1.417			0.955
10 3/8"	9.5	71.5	60	120	36	M6	10	0.420
	0.374	2.815	2.362	4.724	1.417			0.924
15 1/2"	15	73	70	120	36	M6	26	0.620
	0.591	2.874	2.756	4.724	1.417			1.364
20 3/4"	20	79	76	139	42	M6	50	0.910
	0.787	3.123	2.992	5.472	1.653			2.002
25 1"	25	83	92	139	42	M6	68	1.190
	0.984	3.268	3.622	5.472	1.653			2.618
32 1-1/4"	32	95	105	193	50	M8	120	1.930
	1.260	3.740	4.134	7.598	1.968			4.246
40 1-1/2"	38	101	120	193	70	M8	170	2.780
	1.496	3.976	4.724	7.598	2.756			6.116
50 2"	50.5	113	138	193	70	M8	360	4.750
	1.988	4.449	5.433	7.598	2.756			10.450
65 2-1/2"	65	137.5	170.5	244	102	M8	510	8.630
	2.559	5.413	6.713	9.606	4.016			18.986
80 3"	78	147.5	191	244	102	M8	900	13.460
	3.071	5.807	7.520	9.606	4.016			29.612

PRESSURE-TEMPERATURE RATING

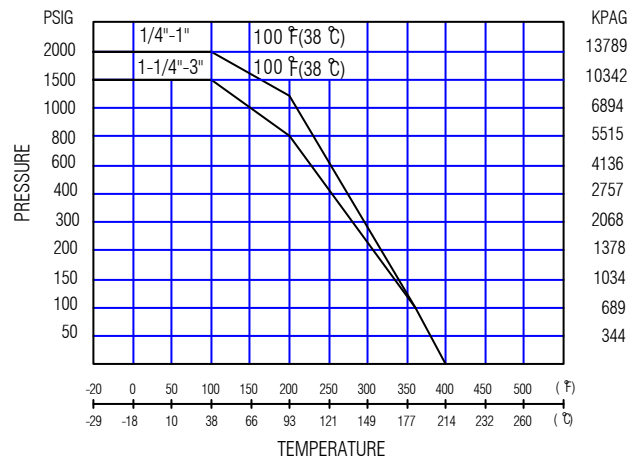

DRAWING NO. LAI0332

REVISION NO. A0